

FINAL NEWSLETTER – SPRING 2003

Project Overview

The purpose of the Reach 1 design project was to prepare preliminary plans for the reconstruction of Reach 1 of Cherry Creek South Drive (from University to Colorado Blvd). The design project, which has extended from Spring 2002 to Spring 2003, is a follow-up to the Master Plan, approved in June 2000. The design plans are based on the recommendations made in the Master Plan and aim to improve the movement and safety of pedestrians, bicyclists and autos. Protecting the corridor's environmental and recreational resources was a key priority of the project.



Cherry Creek South Drive, looking west in the vicinity of Harrison Street

Corridor Design Plan

A cross-section of the Cherry Creek South Drive Reach 1 Corridor design plan is shown in the image above. The design of the corridor includes maintaining a two-lane roadway, while improving the safety for vehicular, pedestrian and bicycle travel. Starting with the Master Plan recommendations, the design plans then incorporated public feedback received throughout the project, while adhering to space limitations and the guidelines established by local agencies and City departments. The corridor will be benefited by:

- Adding continuous sidewalks on the south and north sides of the street
- Enhancing pedestrian safety with median refuges and crossing areas
- Preserving the natural habitat of the Creek
- Improving the multi-use trail on the north side of the Creek to separate pedestrians and bicyclists
- Improving the Alameda Avenue and Steele Street intersection with the addition of a traffic signal and crosswalks
- Providing adequate on-street parking as recommended in the Master Plan
- Adding landscaping along street and in medians



Reach 1 Design of *Cherry Creek South Drive Corridor*

Overview of Public Open House #2

The second public open house was held on March 11, 2003 at the Central Christian Church. A formal presentation was provided to review the proposed design plans for Reach 1. Before and after the presentation, attendees viewed plan elements shown on maps and graphics posted around the room and provided their comments to team staff. Over 120 members of the general public attended the open house/presentation. Attendees expressed their comments verbally during the comment period and by completing written comment forms. A list of all comments is available by contacting Dennis Ohlrogge at the City. The key themes are provided below.

Project Plans/Schedule

- Many attendees voiced their support for the design plans and would like construction in the Corridor to begin soon!
- Future construction is tied to the availability of funds.

Multi-use Trail

- Attendees support the separated pedestrian and bicycle paths on the north side of the Creek.
- The commuter bike trail recommended in the Master Plan is not needed on the south side of the Creek.

Preservation of Natural Habitat

- Preservation of the natural habitat of the Creek is important.
- Many support design plans because they do not infringe onto Creek habitat.

Alameda Intersection

- The roundabout vs. traffic signal issue at Alameda and Cherry Creek South Drive was discussed. A traffic signal is preferable because it does not encroach on the natural habitat and is safer for pedestrians to cross.

Safety/Crossing Facilities

- Most are eager for the continuous sidewalk to be added to the south side of the street.
- The traffic signal at Alameda provides protected crossing for pedestrians.
- Medians are provided to also improve safety for pedestrian to cross the street.

Parking

- On-street parking to be provided as shown in Master Plan.
- The removal of parking spaces is a major concern for many open house attendees.
- Need to resolve resident/visitor parking issue in area around Cherry Creek Towers.

Traffic Lanes

- Maintain current two-lane roadway.
- Provide additional left-turn lanes.
- Medians to be provided for pedestrian safety and traffic calming.



Reach 1 Design of *Cherry Creek South Drive Corridor*

Steele Street

The Steele Street closure recommended in the Master Plan is the topic of a separate study effort. A stakeholders committee has been formed to look at alternatives for the Steele Street corridor. For an update on this process, please call Pat Noyes of Pat Noyes & Associates at 303-440-8171 or email her at pat@patnoyes.com.

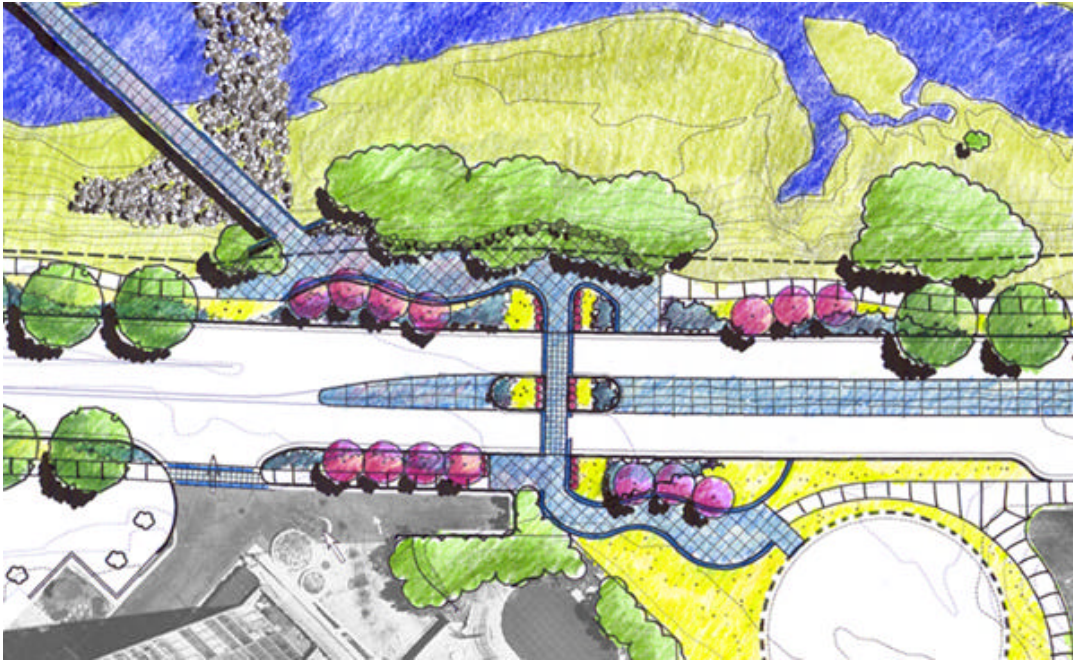

Proposed Steele Street crossing, showing Steele Street bridge at top left and closure of Steele Street

Next Steps

The second public open house concludes the public involvement process for this project. The project team recognizes that the following two key elements still need to be refined and addressed in the coming months:

- Parking in the vicinity of Cherry Creek Towers
- The closure of Steele Street

The project team will continue to meet with individual homeowner associations and property owners regarding these specific areas of concern throughout the next couple of months. The next phases of work will begin as funding is identified and project segments are prioritized.

Web Site

Informational updates on the project will be posted on the City's web site at www.denvergov.org. Please click on "About Denver" then "Transportation" and then "Transportation Division." Then click on "Current Projects" in the yellow column on the left. This will lead you to the Cherry Creek South Drive project page.



Dennis Ohlrogge
City & County of Denver, Public Works
201 W Colfax Ave, Dept. 506
Denver, CO 80202

**City of Brest Park Public Meeting
Wednesday, April 23, 2003 at 6:30 pm**

Central Christian Church, 3690 Cherry Creek South Drive

A design concept is being developed for improvements to the City of Brest Park to improve parking and walking paths in the area. Please join us at this neighborhood workshop to discuss the proposed improvements and plan for the Park. Please contact Ruth Murayama for more information.

Contact Information

Dennis Ohlrogge, City & County of Denver Public Works
Email: dennis.ohlrogge@ci.denver.co.us
Phone: 720-913-4546

Ruth Murayama, City & County of Denver Parks &
Recreation
Email: ruth.murayama@ci.denver.co.us
Phone: 720-913-0613