

 <b>HIGHWAY TECHNOLOGIES</b> Rental, Sales, Service Traffic Control, Sign Manufacturing & Installation - Guardrail Sales & Installation - Pavement Marking - Contractor Supplies	Traffic Control Division 2385 South Lipan St. Denver, CO 80232 Phone: (303) 922-7815 Fax: (303) 922-5433
	<b>TRAFFIC CONTROL PLAN</b> Location: 14th & Delaware City: Denver, CO For: Denver Police Department Lt. Vince Porter Date: May 1st, 2009 Drawn By: Rusty Reynolds

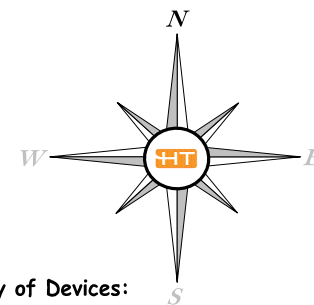

Summary of Devices:

- 2 - Road Work Ahead
- 2 - Left Lane Closed Ahead
- 2 - Merge Right
- 1 - Road Closed
- 1 - Detour Ahead
- 1 - T3 w/ Road Closed / Detour Right
- 1 - T3 w/ Road Closed / Do Not Enter
- 3 - T3s Plain
- 1 - Do Not Enter
- 1 - No Right Turn
- 2 - No Left Turn
- 30 - Glo Posts
- 1 - Arrowboard

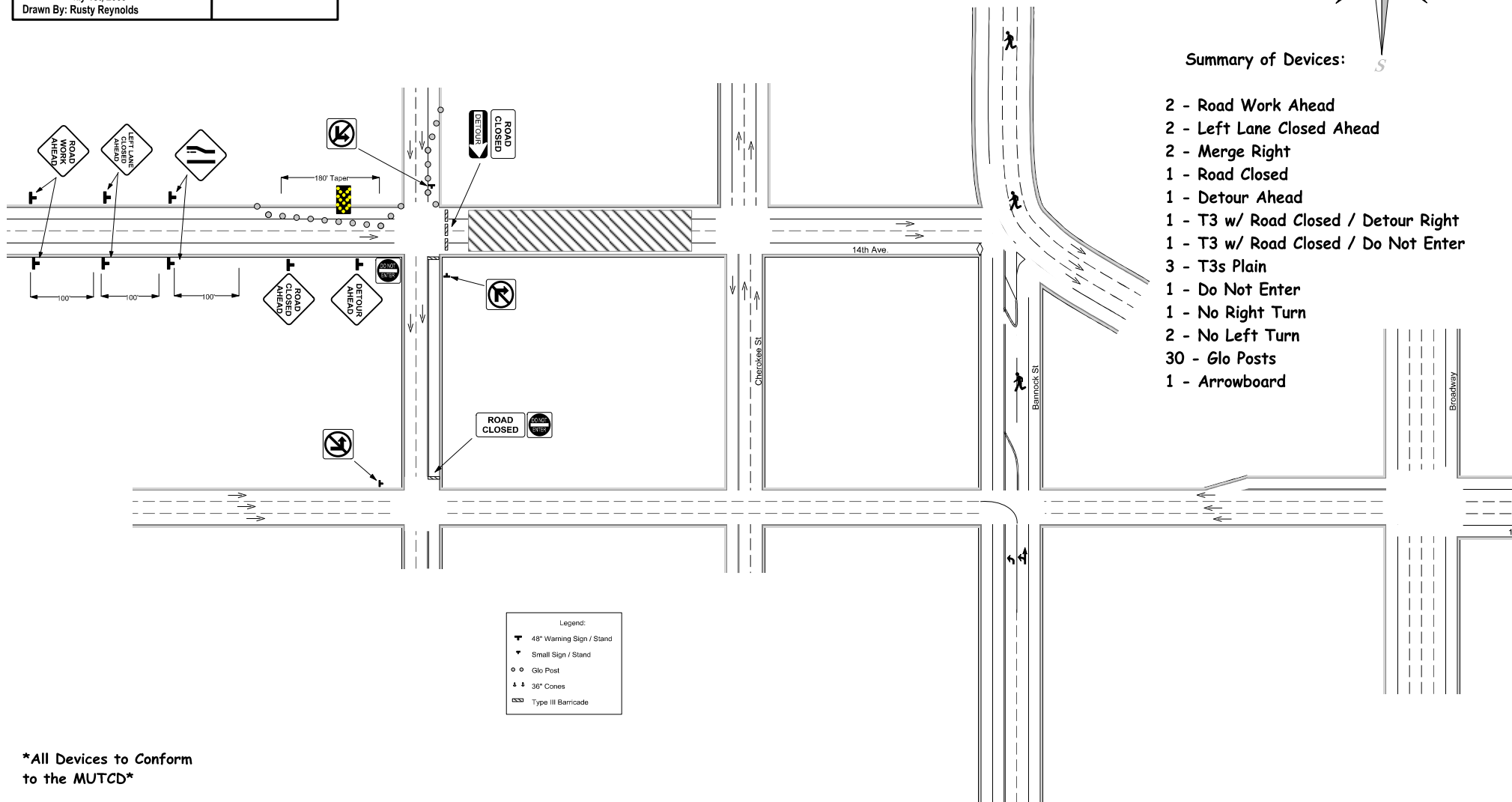

\*All Devices to Conform to the MUTCD\*