

# 2009 Sniagrab Outside Layout

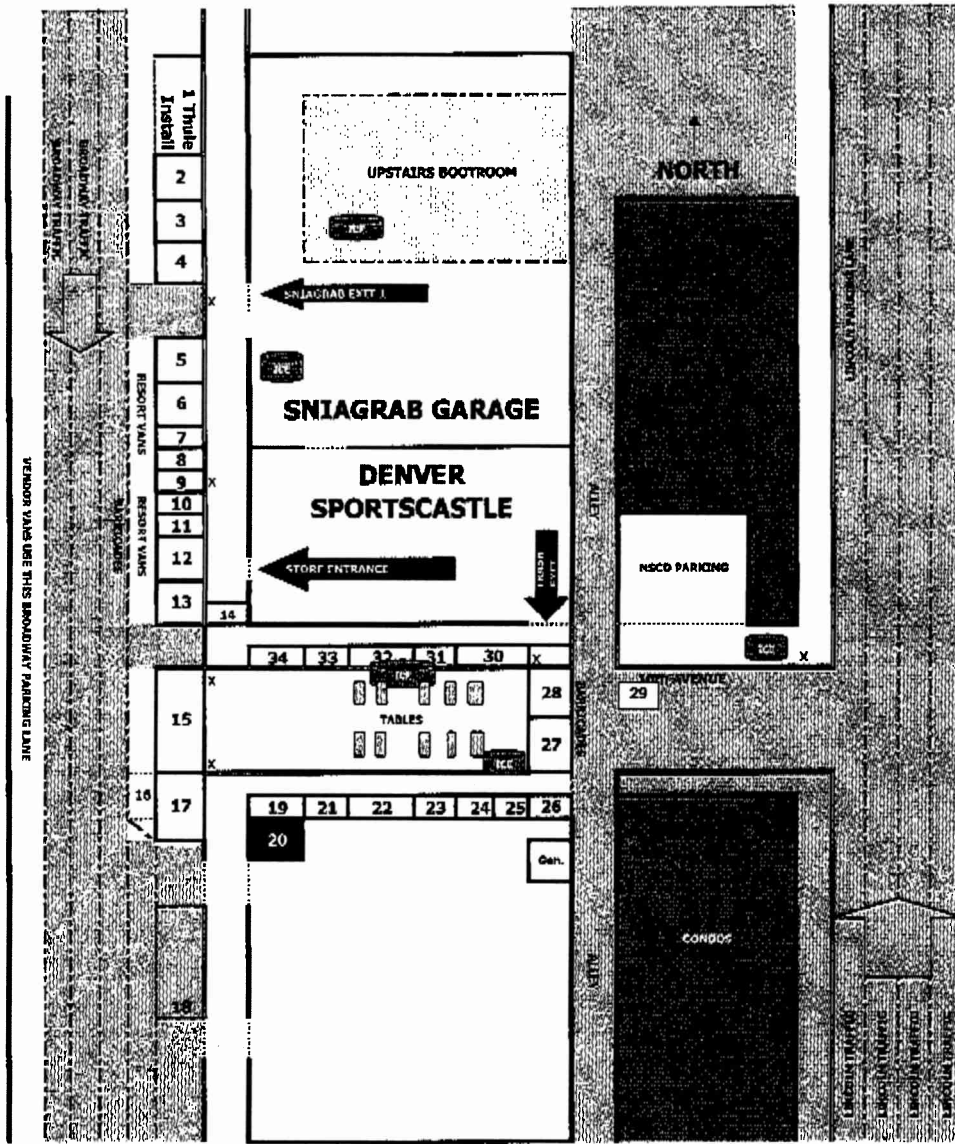

## KEY:

- |  |   |
|--|---|
| 1 Thule Install Area   | 30 Pepsi Truck - Dropped 8/28 1:00pm (Power)      |
| 2 Thule Tent 10x10   | 31 Sound/DJ Tent 10x10 (Power)                    |
| 3 Package Pick-up Tent 10x10                                     | 32 Saturday Morning Donuts & Coffee Table (Power) |
| 4 Tiered Purchase Tent 10x10                                     | 33 Register to Win Entry Table Tent 10x10         |
| 5 Vail Resorts Tent 10x20 (Power)                                | 34 Register to Win Car                            |
| 6 A-Basin Tent 10x20 (Power)                                     |   |
| 7 Eldora Tent 10x10 (Power)                                      |   |
| 8 Search & Rescue Tent 10x10 (Power)                             |   |
| 9 NSCD Tent 10x10 (Power)  |   |
| 10 JSL/Ski Services Tent 10x10                                   |   |
| 11 Crested Butte Tent 10x10 (Power)                              |   |
| 12 Loveland Tent 10x20 (Power)                                   |   |
| 13 Echo Mountain Tent 10x20 (Power)                              |   |
| 14 Hot Dog Cart  |   |
| 15 Winter Park/Copper/Steamboat & Pass Wagon Space 10x30 (Power) |   |
| 16 Woody's Oven  |   |
| 17 Woody's Serving Cart  |   |
| 18 Woody's Refrigerator Truck                                    |   |
| 19 Radio Remote Tent 10x10                                       |   |
| 20 Radio Remote Trucks (2 parking spaces)                        |   |
| 21 OPEN - Tent 10x10 back up Radio Remote & Food                 |   |
| 22 Santiago's Tent 10x20 (Power)                                 |   |
| 23 Jamba Juice Tent 10x10  |   |
| 24 Taste of Philly Tent 10x10 (Power)                            |   |
| 25 Taste of Philly Grill Space                                   |   |
| 26 Vitamin Water Mini Van  |   |
| 27 MUST LEAVE OPEN FOR EMERGENCY                                 |   |
| 28 OPEN  |   |
| 29 NSCD Canopy 10x10   |   |

## NOTES:

- 10a-7p Food Hours Each Day
- (ice) = ice trough for bottled water
- x = speakers
- \* Pepsi needs H2O hookup

## Sale Hours:

- Thursday - 11 to 7pm
- Friday - 11 to 7pm
- Saturday - 8 to 10pm
- Sunday - 9 to 8pm
- Monday - 9 to 9:30pm

## Food Hours:

- Friday - none specified
- Saturday - 10 to 7pm
- Sunday - 10 to 7pm
- Monday - 10 to 6pm

# TRAFFIC CONTROL PLAN

LOCATION: 10th Ave. & Broadway

Denver, CO, 80204

DATE: 6/12/13 (Revised 7/18/04)

FOR: Gert S. [unclear]

BY: United Rentals Highway Technologies  
Ph: 303.922.7815, Fax: 303.922.5438

## SUMMARY OF DEVICES:

- 4-ROAD WORK AHEAD
- 2-LEFT LANE CLOSED AHEAD
- 2-MERGE RIGHT SYMBOLS
- 2-ROAD CLOSED AHEAD
- 2-DETOUR AHEAD
- 1-4-W/ROAD CLOSED TO THRU TRAFFIC DETOUR RIGHT
- 4-T-R PLAN
- 25-8" W BARRICADES
- 1-14 STREET CLOSED
- 8-DETOUR RIGHT
- 4-DETOUR LEFT
- 45-VERTICAL PANELS
- 1-FLASHING ARROW PANEL
- 60'SAFETY FENCE



### Notes\*

- 1-sidewalks to remain clear for hand-cap access. *206*
- 2 -All items relating to sale must remain in the traffic control zone
- 3-Alley access to be maintained for construction and planned parenthood.

## MHT #1

Sign spacing - 200' min.  
Taper length - 180' min.

### LEGEND:

- = 48" WARNING SIGN
- ◻ = DRUM / VERTICAL PANEL W/PL
- = DRUM
- ⊥ = VERTICAL PANEL / SIGN
- ▨ = ARROWBOARD TYPE - C
- = WORK ZONE

- 1 - MUST KEEP SIDEWALKS CLEAR FOR HANDICAP ACCESS
- 2 - ALL ITEMS RELATING TO SALE MUST STAY WITHIN TCD
- 3 - MAINTAIN ALLEY ACCESS
- 4 - CONTRACTOR TO RESUME ALL LOCAL ACCESS & SAFETY VEHICLES
- 5 - PLANS APPROVED

*[Handwritten Signature]*  
5/17/13  
2005-R63901

