

Legend

Hale - Jan-Sep 2020

Number of Reported Crimes

- 1 - 2
- 3 - 4
- 5 - 7
- 8 - 11
- 12 - 37

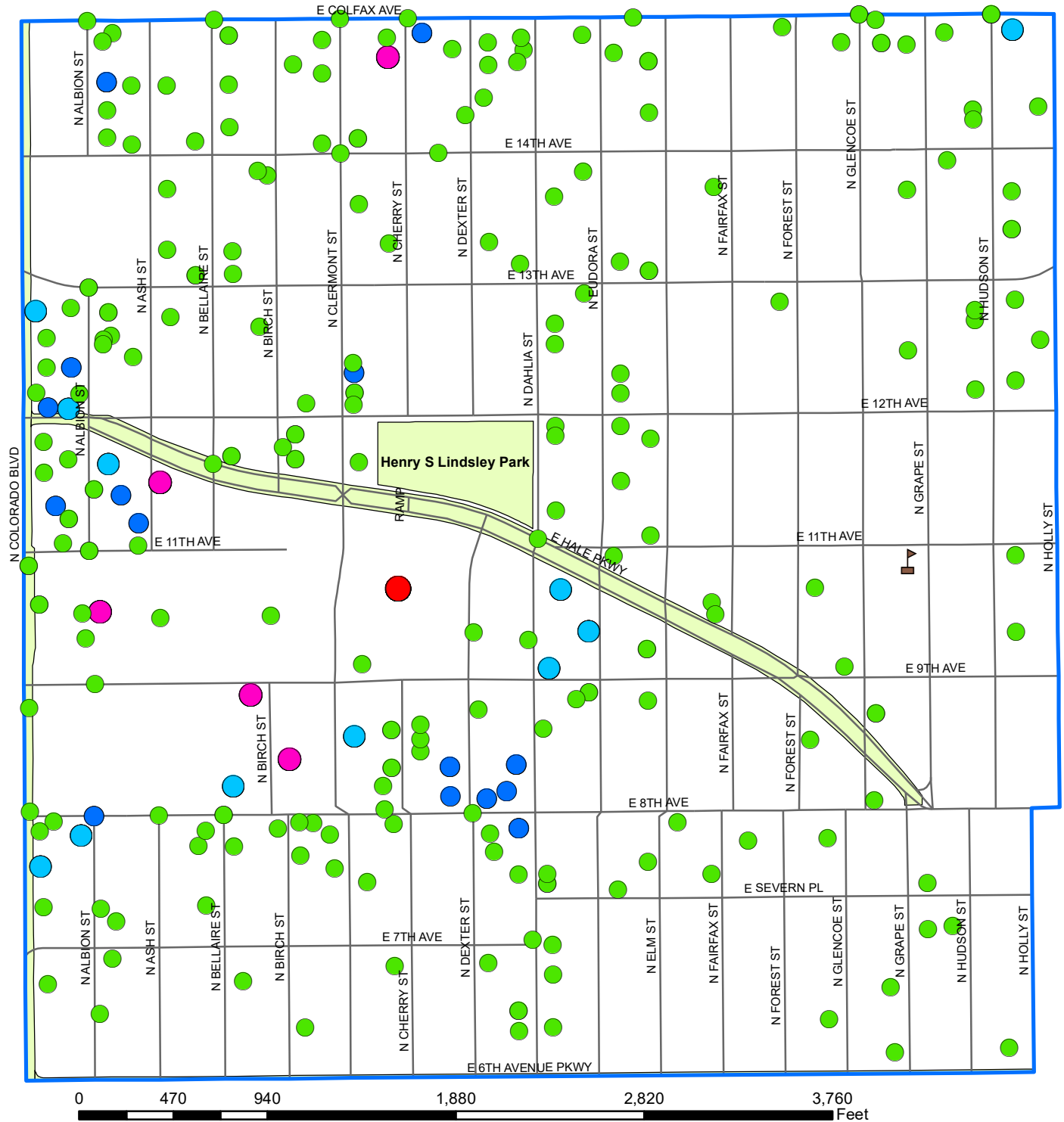

PART 1 CRIME IN HALE REPORTED OFFENSES BASED ON UCR STANDARDS

TYPE OF OFFENSE		JAN-SEP 2019		JAN-SEP 2020		CHANGE	
		#	%	#	%	#	%
VIOLENT CRIME	Murder	1	0.5%	0	0.0%	-1	-100.0%
	Rape	6	3.2%	4	1.4%	-2	-33.3%
	Robbery	4	2.1%	4	1.4%	0	0.0%
	Aggravated Assault	15	7.9%	13	4.5%	-2	-13.3%
SUBTOTAL		26	13.7%	21	7.3%	-5	-19.2%
PART 1 PROPERTY	Burglary	26	13.7%	50	17.4%	24	92.3%
	Larceny (Except Theft from MV)	52	27.4%	79	27.4%	27	51.9%
	Theft from Motor Vehicle	47	24.7%	96	33.3%	49	104.3%
	Auto theft	38	20.0%	42	14.6%	4	10.5%
	Arson	1	0.5%	0	0.0%	-1	-100.0%
SUBTOTAL		164	86.3%	267	92.7%	103	62.8%
PART 1 TOTAL		190	100.0%	288	100.0%	98	51.6%

All files utilized in the creation of this report are dynamic. Dynamic files allow additions, deletions and/or modifications at any time, resulting in more complete and accurate records in the databases. Due to continuous data entry after reports are compiled, numbers may vary in previous or subsequent reports. .

PREPARED TO DEPARTMENT OF SAFETY PUBLIC INFORMATION STANDARDS

Excludes runaways, traffic offenses, unfounded reports and non-criminal activity.

HALE REPORTED OFFENSES USING NIBRS DEFINITIONS

TYPE OF OFFENSE		JAN-SEP 2019		JAN-SEP 2020		CHANGE	
		#	%	#	%	#	%
CRIMES AGAINST PERSONS	Murder	1	0.3%	0	0.0%	-1	-100.0%
	Aggravated Assault	15	4.1%	13	3.1%	-2	-13.3%
	Forcible Sex Offenses	6	1.6%	4	0.9%	-2	-33.3%
	Non-Forcible Sex Offenses	0	0.0%	0	0.0%	0	NA
	Kidnapping/Abduction	0	0.0%	1	0.2%	1	NA
	Simple Assault	40	10.9%	21	4.9%	-19	-47.5%
	Intimidation	12	3.3%	6	1.4%	-6	-50.0%
	SUBTOTAL	74	20.2%	45	10.6%	-29	-39.2%
CRIMES AGAINST PROPERTY	Arson	1	0.3%	0	0.0%	-1	-100.0%
	Bribery	0	0.0%	0	0.0%	0	NA
	Burglary	26	7.1%	51	12.0%	25	96.2%
	Counterfeiting/Forgery	2	0.5%	0	0.0%	-2	-100.0%
	Criminal Mischief/Damaged Property	42	11.5%	51	12.0%	9	21.4%
	Embezzlement	0	0.0%	0	0.0%	0	NA
	Extortion	0	0.0%	0	0.0%	0	NA
	Fraud	15	4.1%	15	3.5%	0	0.0%
	Larceny	53	14.5%	79	18.5%	26	49.1%
	Theft from Motor Vehicle	47	12.8%	96	22.5%	49	104.3%
	Motor Vehicle Theft	38	10.4%	42	9.9%	4	10.5%
	Robbery	4	1.1%	4	0.9%	0	0.0%
Stolen Property	0	0.0%	0	0.0%	0	NA	
	SUBTOTAL	228	62.3%	338	79.3%	110	48.2%
CRIMES AGAINST SOCIETY	Drug/Narcotics Violations	11	3.0%	2	0.5%	-9	-81.8%
	Gambling	0	0.0%	0	0.0%	0	NA
	Child Pornography	1	0.3%	0	0.0%	-1	-100.0%
	Prostitution	0	0.0%	0	0.0%	0	NA
	Weapon Law Violations	1	0.3%	8	1.9%	7	700.0%
	SUBTOTAL	13	3.6%	10	2.3%	-3	-23.1%
ALL OTHER OFFENSES	Fraud - NSF - Closed Account	0	0.0%	0	0.0%	0	NA
	Curfew	1	0.3%	0	0.0%	-1	-100.0%
	Disorderly Conduct / Disturbing the Peace	8	2.2%	3	0.7%	-5	-62.5%
	Family Offenses / Nonviolent	6	1.6%	2	0.5%	-4	-66.7%
	Liquor Law/Drunkenness	3	0.8%	1	0.2%	-2	-66.7%
	Other Sex Offenses	2	0.5%	1	0.2%	-1	-50.0%
	Violation of a Restraining/Court Order	11	3.0%	6	1.4%	-5	-45.5%
	Harassment	0	0.0%	4	0.9%	4	NA
	Criminal Trespassing	9	2.5%	12	2.8%	3	33.3%
All Other Offenses	11	3.0%	4	0.9%	-7	-63.6%	
	SUBTOTAL	51	13.9%	33	7.7%	-18	-35.3%
GRAND TOTAL		366	100.0%	426	100.0%	60	16.4%

All files utilized in the creation of this report are dynamic. Dynamic files allow additions, deletions and/or modifications at any time, resulting in more complete and accurate records in the databases. Due to continuous data entry after reports are compiled, numbers may vary in previous or subsequent reports.

PREPARED TO DEPARTMENT OF SAFETY PUBLIC INFORMATION STANDARDS
Excludes runaways, traffic offenses, unfounded reports and non-criminal activity.